

# Accessories

## Accessori

### For aluminium plinth

Per zoccolo in alluminio

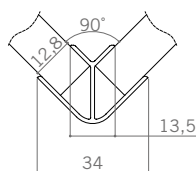

**cod. 364**

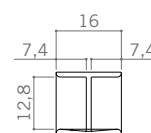

**cod. 368 A**

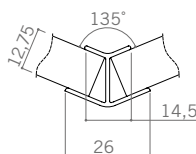

**cod. 365**



**cod. 370 A**

| CODE<br>CODICE | height H<br>altezza H<br>(mm) | pieces per box<br>pezzi per scatola<br>(pcs) | weight per box<br>peso per scatola<br>(kg) |
|----------------|-------------------------------|--|--|
| <b>364 1</b>   | 100                           | 50   | 1,5  |
| <b>364 2</b>   | 120                           | 50   | 1,8  |
| <b>364 3</b>   | 150                           | 50   | 2,1  |
| <b>365 1</b>   | 100                           | 50   | 1,1  |
| <b>365 2</b>   | 120                           | 50   | 1,3  |
| <b>365 3</b>   | 150                           | 50   | 1,6  |

| CODE<br>CODICE | height H<br>altezza H<br>(mm) | pieces per box<br>pezzi per scatola<br>(pcs) | weight per box<br>peso per scatola<br>(kg) |
|----------------|-------------------------------|--|--|
| <b>368 A1</b>  | 100                           | 50   | 1,1  |
| <b>368 A2</b>  | 120                           | 50   | 1,2  |
| <b>368 A3</b>  | 150                           | 50   | 1,4  |
| <b>370 A1</b>  | 100                           | 100  | 1  |
| <b>370 A2</b>  | 120                           | 100  | 1,2  |
| <b>370 A3</b>  | 150                           | 100  | 1,4  |